

Project: _____

Type: _____

Drawn by: _____ Catalogue #: _____

Date: _____



DOME - RDS

4" LED RECESSED DOWNLIGHT

With adjustable trim

FEATURES AND SPECIFICATIONS

• Construction

Housing

Housing constructed of heavy duty galvanized steel with built-in thermal protection.

Trim

Trims constructed with cold rolled steel. Available in white and black.

LED

Color temperatures available in 2 700 K, 3 000 K, 3 500 K and 4 000 K, with a choice of 80+ CRI and 90+ CRI.

Driver

120 V, 277 V or 347 V, 0-10 V dimming standard.

Optics/lens

Standard lens that allows for desired beam angles.

Aiming

- 58° maximum tilt
- 270° rotation

Lumens

738 to 1 893 lm

Beams

- Spot (16°)
- Narrow Flood (24°)
- Flood (36°)

Reflectors

Plastic lens.

• Compliances

- cCSAus listed for damp location
- Photometric testing in compliance with IES LM79-80
- ICES 005



LED
fixture



dimmable
fixture



damp
location



ICES
005



C SA US

OVERVIEW

Light source	LED
Watts (W)	9 - 22
Lumen output (lm)	738 - 1 893
Efficiency (lm/W)	82 - 86
Color temperature (K)	2 700, 3 000, 3 500, 4 000
CRI	80+, 90+
Weight (lbs)	2.65 - 3.72

ORDERING GUIDE - TRIMS

Series	Lumen package (lm)	CRI	Trim color	Color temp. (K)	Beam angle ²
RDS	08 - 738 - 1 010 10 - 923 - 1 263 15 - 1 384 - 1 893	80 - 80+ 90 - 90+	W - White B ¹ - Black	27K - 2 700 30K - 3 000 35K - 3 500 40K - 4 000	S - Spot N - Narrow flood F - Flood

¹ Available on request, please contact factory.

² Refer to Beam distribution chart for more details.

ORDERING GUIDE - HOUSINGS

Series	Lumen package ¹	Volts (VAC)
RDS - Non IC	08 ²	A - 120
RDSRM - Remodeler	10	E - 277
	15	H - 347

¹ Please note that each housing and trim should correspond to a specific lumen package. For more information, please see Trims Ordering Guide above.

² Only available in 120 V or 277 V.

TECHNICAL SPECIFICATION TABLE

Lumen package	Watts (W)	Volts (VAC)	2 700 K		3 000 K		3 500 K		4 000 K		CRI	Life L70 (hrs)	Type of distrib.	Power factor	THD (%)
			Lumen (lm)	Efficiency (lm/W)	Lumen (lm)	Efficiency (lm/W)	Lumen (lm)	Efficiency (lm/W)	Lumen (lm)	Efficiency (lm/W)					
08	10	120	880	88	916	92	944	94	953	95	80+	36 000	Narrow Flood	>0.9	<20
10	13	120	1 100	85	1 145	88	1 180	91	1 191	92	80+	36 000	Narrow Flood	>0.9	<20
15	19	120	1 648	87	1 717	90	1 768	93	1 786	94	80+	36 000	Narrow Flood	>0.9	<20

COMPATIBLE DIMMERS¹ - 0-10 V DIMMERS

Brand	Model number
Leviton	IP710-DLZ, IP710DLX, CFCS, DS710
Legrand	CD4FBW, WS4FBL3P
Lutron	NOVA NFTV, T NTSTV, DIVA DDTV, DVSCV
WATTSTOPPER	ADF-120277

¹ Dimming range: 10%-100%.

Note: The above table shows dimmers that have been tested and have demonstrated proper operation under normal conditions. Each installation being unique, various factors such as load, common neutrals or other electrical products on the circuit can, in certain instances, cause variance in system performance. Read and comply to the dimmer installation instructions. Consult dimming system manufacturer for additional support in operation. Standard recommends to use dimmers designed to work with LED products. Older dimmers designed for incandescent products may cause erratic operation. Some dimmers may require more than one product for stable operation. The maximum number of products is determined by the dimmer wattage rating with LEDs. Be careful, these dimmers have different ratings depending on the product type. Again, refer to the dimmer installation instructions.

DIMENSIONS

RDS

NON-IC FRAME-IN KIT

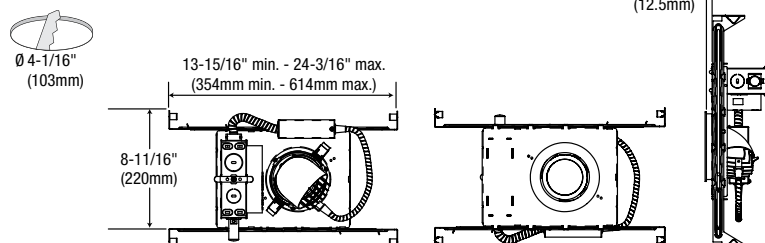

RDSRM

REMODELER

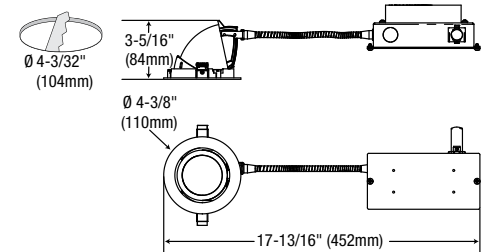

Data is based upon tests performed in a controlled environment. Actual performance can vary depending on operating conditions. All products are subject to change or may be discontinued any time without notice.

PHOTOMETRIC DATA¹

RDS-0880-XX-30K-N • 916.2lm

Polar candela distribution

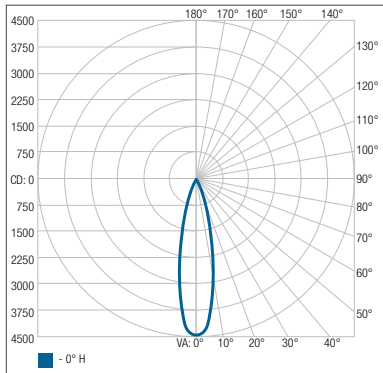

Zonal lumen summary

Zone	Lumens	% Fixture
0-30	796	86.9%
0-40	841.5	91.9%
0-60	887	96.8%
60-90	29.1	3.2%
70-100	14.3	1.6%
90-120	0	0%
0-90	916.2	100%
90-180	0	0%
0-180	916.2	100%

Illuminance at a distance

	Center beam fc	Beam width
1.7'	1 536 fc	0.7'
3.3'	408 fc	1.3'
5.0'	178 fc	2.0'
6.7'	98.9 fc	2.7'
8.3'	65.5 fc	3.3'
10'	44.4 fc	4.0'

■ Beam spread: 22.4°

RDS-1080-XX-30K-N • 1 145.2 lm

Polar candela distribution

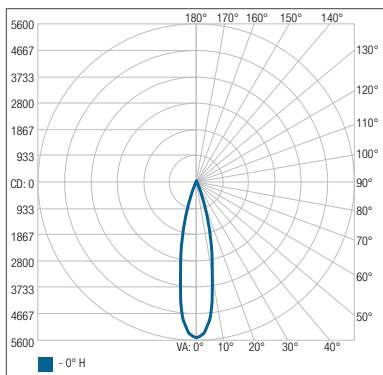

Zonal lumen summary

Zone	Lumens	% Fixture
0-30	995	86.9%
0-40	1 051.9	91.9%
0-60	1 108.8	96.8%
60-90	36.4	3.2%
70-100	17.9	1.6%
90-120	0	0%
0-90	1 145.2	100%
90-180	0	0%
0-180	1 145.2	100%

Illuminance at a distance

	Center beam fc	Beam width
1.7'	1 920 fc	0.7'
3.3'	510 fc	1.3'
5.0'	222 fc	2.0'
6.7'	124 fc	2.7'
8.3'	80.6 fc	3.3'
10'	55.5 fc	4.0'

■ Beam spread: 22.4°

RDS-1580-XX-30K-N • 1 717.0 lm

Polar candela distribution

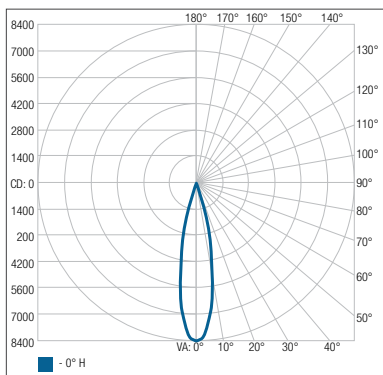

Zonal lumen summary

Zone	Lumens	% Fixture
0-30	1 491.7	86.9%
0-40	1 577.0	91.9%
0-60	1 662.3	96.8%
60-90	54.6	3.2%
70-100	26.9	1.6%
90-120	0	0%
0-90	1 717.0	100%
90-180	0	0%
0-180	1 717.0	100%

Illuminance at a distance

	Center beam fc	Beam width
1.7'	2 879 fc	0.7'
3.3'	764 fc	1.3'
5.0'	333 fc	2.0'
6.7'	185 fc	2.7'
8.3'	121 fc	3.3'
10'	83.2 fc	4.0'

■ Beam spread: 22.4°

¹ Complete IES files available on our website.

Data is based upon tests performed in a controlled environment. Actual performance can vary depending on operating conditions. All products are subject to change or may be discontinued any time without notice.