

## Series Spec Sheet

# POWER SUPPLIES

## 24 V DC LED DRIVERS

### Class 2

Stanpro's 24 V constant voltage power supplies are available in a variety of wattage options, dimming and connection type to support our LED tape systems and undercabinet low voltage luminaires. Accessible for many indoor and outdoor applications.

### FEATURES AND SPECIFICATIONS

#### • Construction

- White and Black frame
- Enclosed in a surface mountable junction box or
- Enclosed in a fully isolated plastic case

#### • Electrical

- Constant Voltage
- High efficiency up to 88%
- Suitable options:
  - Dry location use IP20
  - Wet or damp location use IP67
- Warranty: 2 years for plug-in and 3 years for hardwired
- Ambient temperature range -25°C to 50°C

#### Hardwire Dimmable:

- Full protection aluminum housing
- Input range: 100-130 V AC
- TRIAC, Forward and reverse phase
- Cooling by free air convection
- Protections: short-circuit, over loading and over current
- Flicker-free dimming
- Built-in active PFC function

#### Hardwire Non-dimmable:

- Housing also serves as a junction box
- Input range: 100-277 V AC
- Protection: over current

#### Plug-In Non-dimmable:

- Input range: 100-240 V AC
- Leakage current less than 0.25mA at 240 V AC



### OVERVIEW

Light source	LED
Watts (W)	50- 96



**quick  
ship**



**constant  
volts**



**CLASS  
2  
compliant**



**QUICK SHIP AND TECHNICAL SPECIFICATION TABLE**

Order code	Model number	DC connector	Watts (W)	Volts (VAC)	Output Volts (VAC)	Input Current (mA)	Frequency (Hz)	Power factor	Efficiency	IP rating	Operating Temperature (Range)	Warranty (yrs)	Master case qty	
														(Yes/No)
<b>Hardwired - Dimmable</b>														
65741	LED/DRIVER/50W/24V/HW/D/STD	No	50	100-130	24	410	50/60	0.95	84%	IP20	-10°C to 40°C	3	20	
65742	LED/DRIVER/96W/24V/HW/D/STD	No	96	100-130	24	800	50/60	0.95	87%	IP67	-10°C to 40°C	3	10	
<b>Plug-in - Non-dimmable</b>														
65750	LED/DRIVER/60W/24V/PLUG/ND/STD	XY-60S-2402500Q-UD	Yes	60	100-240	24	1 500	50/60	0.5	88%	IP20	0°C to 40°C	2	36

**COMPATIBLE DIMMERS<sup>1</sup>**

Brand	Model number
COOPER	DAL06P, SLC03P
LEVITON	IPL06, 6674, DSL06-1LZ, DSM10-1LZ, IPE04-1LZ
LUTRON	PD-6WCL, DVCL-153P, CTCL-153P, DVCL-253P, AYCL-253P, DVELV-300P, MACL-153P

Dimming range: 10%-100%

<sup>1</sup> This table shows dimmers that have been tested and have demonstrated proper operation under normal conditions. Each installation being unique, various factors such as load, common neutrals or other electrical products on the circuit can, in certain instances, cause variance in system performance. Read and comply to the dimmer installation instructions. Consult dimming system manufacturer for additional support in operation. Some dimmers may require more than one product for stable operation. Stanpro recommends to use dimmers designed to work with LED products. Older dimmers designed for incandescent products may cause erratic operation.

**DIMENSIONS**

65741

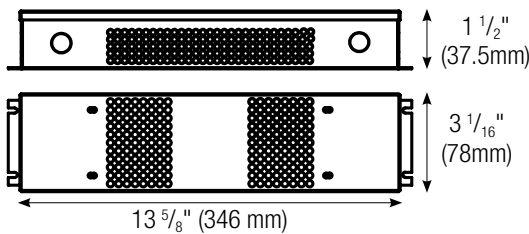

65750

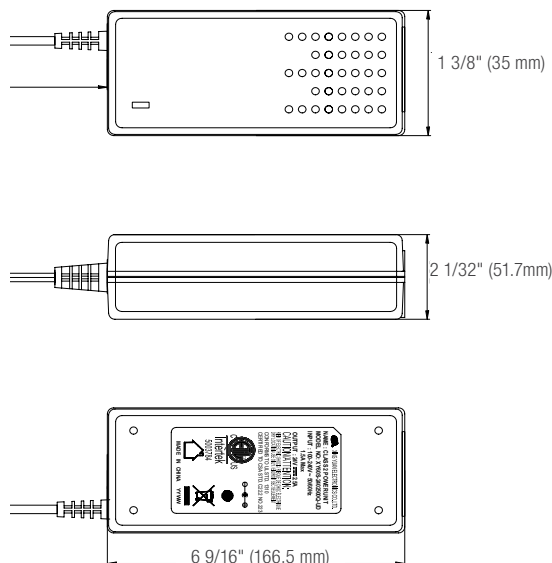

65742

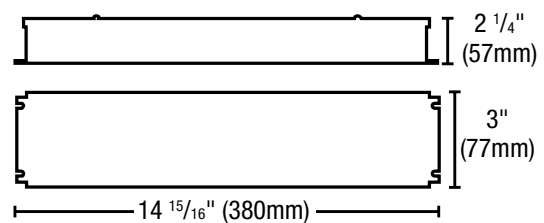

65747

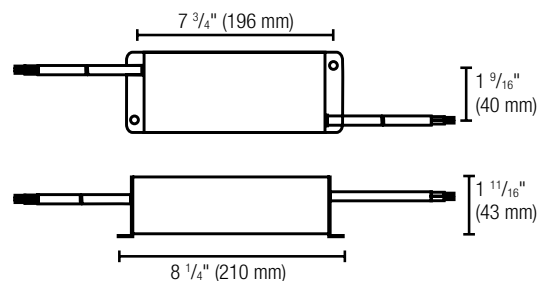

Data is based upon tests performed in a controlled environment. Actual performance can vary depending on operating conditions. All products are subject to change or may be discontinued any time without notice.