

Series Spec Sheet

L2WMG

LED LINKABLE WRAPAROUND

Stanpro's L2WMG is a LED linkable wrap and is available in 2' and 4'. This model is ideal for surface and row mounting with the connector accessories which make it quick and easy to connect the luminaires without any additional wiring. Perfectly suited for a variety of commercial and residential applications, such as utility rooms, corridors, hallways, restrooms, and where a decorative luminaire with efficient lighting is required.

FEATURES AND SPECIFICATIONS

• Construction

Physical Characteristics

- Steel with white powder coated housing
- Frosted polycarbonate lens
- Comes standard with 2 connectors to allow easy and rapid connections:
 - Linkable connector (no cable)
 - 12" linkable cable connector (included only with single CCT)
- For CCT Selectable version, CCT switch located inside the housing.

Mounting

- Surface or row mounted
- Using linkable connector (provided with the product) for row mounting or hardwire through end cap for conduit entry (order separately)
- Row mount up to 8 units for the 2' H.O. and 4' wraps, and up to 15 units for the 2' wrap is possible using the included connectors (see images below in accessories section)
- When using end cap for conduit entry to achieve row dimming, read carefully the dimmer's instruction for a safe wiring and not to exceed maximum capacity of the dimmer used.

• Performance Data

- Available in 4 000 K single color temperature, or 3 000/4 000/5 000 K selectable color temperatures
- 80+ CRI
- Electrical ratings: 120-277 V
- Estimated life of over 72 000 hours to L70
- 0-10 V dimming standard (**dimming with row mounting only available when hardwired using the end cap for conduit entry accessory**)
- 1 kV surge protection (2kV for 69372)
- Operating temperature:
 - 20 °C to 40 °C (-4 °F to 104 °F)
- Operating temperature (69372):
 - 20 °C to 25 °C (-4 °F to 77 °F)

• Compliances

- ETL listed for damp locations
- DLC Standard for certain models (see quickship table for details)
- Meets requirements of ICES-005 issue 5 class B for use in residential applications



OVERVIEW

Light source	LED
Watts (W)	23 - 47
Lumen output (lm)	2 695 - 5 420
Efficacy (lm/W)	106 -120
Color temperature (K)	3 000/4 000/5 000 4 000
CRI	>80



**quick
ship**



**LED
fixture**



**Dimming with row mounting only
available when hardwired**



**damp
location**



**ICES
005**



Not all products are qualified on the DLC QPL. To view our DLC qualified products, please consult the DLC Qualified Products List at www.designlights.org/search.

* 68137 is not dimmable

QUICK SHIP AND TECHNICAL SPECIFICATION TABLE

Order code	Model number	DLC unique ID	Watts	Volts	Color temp.	Lumen output	Efficacy	CRI	Life L70	Tested hours LM-80 (hrs) ⁴	Dimming (Yes/No)	Power factor	THD (%)	Master case qty
			(W)	(V AC)	(K) ¹	(lm)	(lm/W)		(hrs) ⁴					
Dimmable														
2' Single CCT														
68663	L2WMG-24-1-G2	PWTJBGH7	23	120-277	4 000	2 695 ²	115	84	54 000	9 000	Yes ⁵	0.94	12	12
2' High Output CCT Selectable														
69372	L2WMG-24HO-3C-G2	S-JQ2KZH	46	120-277	3 000/4 000/5 000	5 354 ³	116	83	>72 000	12 000	Yes ⁵	0.92	15	12
4' Single CCT														
68377	L2WMG-48-1-G2	P5HN6NQ9	47	120-277	4 000	5 420 ²	116	84	> 54 000	9 000	Yes ⁵	0.90	13	6
4' CCT Selectable														
69165	L2WMG-48-3C-G2	S-1RF2XM	44	120-277	3 000/4 000/5 000	5 274 ³	120	83	54 000	9 000	Yes ⁵	0.90	20	6
Non Dimmable														
4' Single CCT														
68137	L2WMG-48-1	-	47	120-277	4 000	5 043 ²	106	84	54 000	9 000	No	0.90	15	6

¹ Typical color temperature range: +/- 5 %.

² Lumen values are derived from photometric testing. Initial lumens range: +/- 10 %.

³ Lumen values are derived from DLC reported data at 3 000 K. Please refer to the LUMEN SPECIFICATION TABLE for more details on other color temperatures.

⁴ Life hours are derived from IESNA LM-80-08 testing report and projected per IESNA TM-21-11 extrapolations.

⁵ Dimming with row mounting only available when hardwired using the end cap for conduit entry.

LUMEN SPECIFICATION TABLE

Order code	Model number	3 000 K		4 000 K		5 000 K	
		Lumen output (lm)	Efficacy (lm/W)	Lumen output (lm)	Efficacy (lm/W)	Lumen output (lm)	Efficacy (lm/W)
69372	L2WMG-24HO-3C-G2	5 354	116	5 502	120	5 405	118
69165	L2WMG-48-3C-G2	5 228	119	5 408	123	5 188	118

DEFAULT PROGRAMMING

4 000 K

ACCESSORIES (order separately)

Part number	Type
68858	Linkable Connector (No cable) ¹
68859	12" Linkable Cable Connector ^{1,2}
68860	48" Linkable Cable Connector
68861	72" Linkable Cable Connector
68862	96" Linkable Cable Connector
68863	48" Replacement Lens
69065	End cap for conduit entry (set of 2)

¹ One piece is included in the box, extra units can be purchased separately.

² Included only with single CCT version

COMPATIBLE DIMMERS¹

Brand	Model
Leviton	DD 710
	DS 710
Lutron	DVSTV
	NOVA NTSTV DV
Legrand	RH4FBL3PTC
	WS4FBL3P

Dimming range: 10%-100%

¹ This table shows dimmers that have been tested and have demonstrated proper operation under normal conditions. Each installation being unique, various factors such as load, common neutrals or other electrical products on the circuit can, in certain instances, cause variance in system performance. Read and comply to the dimmer installation instructions. Consult dimming system manufacturer for additional support in operation. Some dimmers may require more than one product for stable operation. Stanpro recommends to use dimmers designed to work with LED products. Older dimmers designed for incandescent products may cause erratic operation.

DIMENSIONS (END CAP FOR CONDUIT ENTRY)

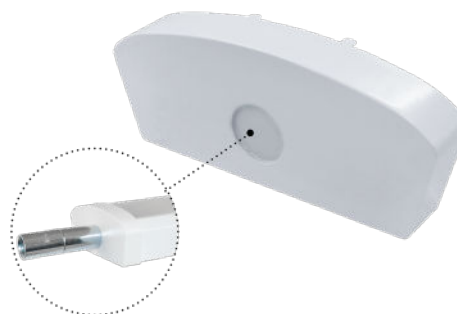
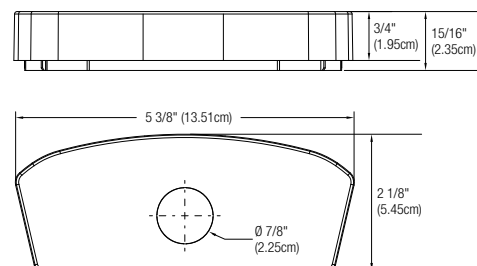

INCLUDED IN THE BOX



Included Connectors*

Luminaire with Linkable Connector

Luminaire with 12" Linkable Cable Connector

*Included only with single CCT version

DIMENSIONS AND WEIGHTS

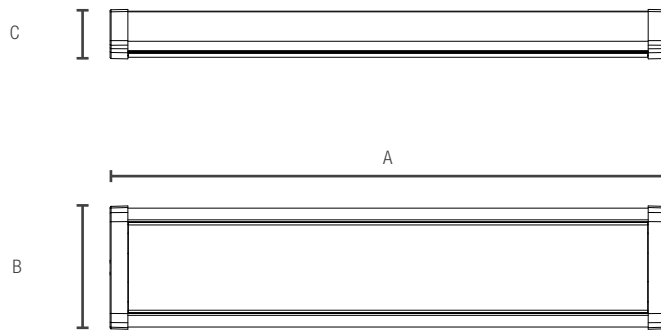

	2'	2' H.O.	4'
A in. (cm)	21.3 (54.2)	24 (61)	48 (119.9)
B in. (cm)	5.5 (13.3)	5.3 (13.5)	5.5 (13.3)
C in. (cm)	1.6 (5.2)	2.1 (5.4)	1.6 (5.2)
Net weight (lbs)	2.65	2.82	4.63

PHOTOMETRIC DATA¹

68663 • L2WMG-24-1-G2 • 2 682.6 lm

Polar candela distribution

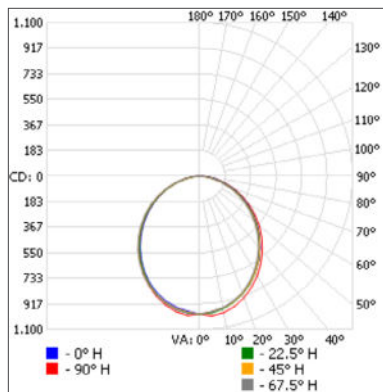

Zonal lumen summary

Zone	Lumens	% Fixture
0-30	752.8	28.1%
0-40	1 216.1	45.3%
0-60	2 099.5	78.3%
60-90	561.3	20.9%
70-100	255.9	9.5%
90-120	12.4	0.5%
0-90	2 660.7	99.2%
90-180	21.8	0.8%
0-180	2 682.6	100%

Illuminance at a distance

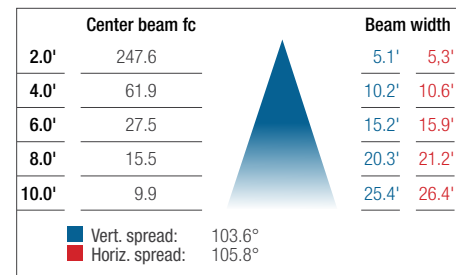

69372 • L2WMG-24HO-3C-G2 • 46 W • 4 000 K • 5 495.2 lm

Polar candela distribution

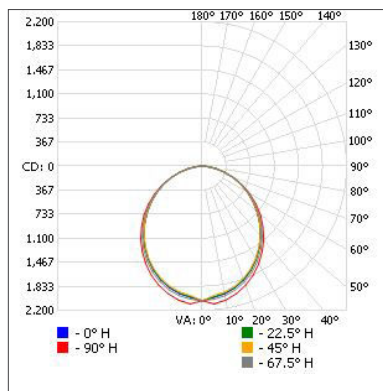

Zonal lumen summary

Zone	Lumens	% Fixture
0-30	1 548.3	28.2
0-40	2 506.7	45.6
0-60	4 337.0	78.9
60-90	1 122.9	20.4
70-100	488.6	8.9
90-120	16.8	0.3
0-90	5 459.9	99.4
90-180	35.4	0.6
0-180	5 495.2	100

Illuminance at a distance

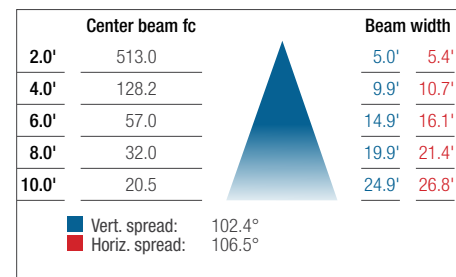

¹ Complete IES files available on our website.

Data is based upon tests performed in a controlled environment. Actual performance can vary depending on operating conditions. All products are subject to change or may be discontinued any time without notice. Please contact your Stanpro customer service representative to confirm inventory levels at time of order.

PHOTOMETRIC DATA¹

68377 L2WMG-48-1-G2 • 5 412 lm

Polar candela distribution

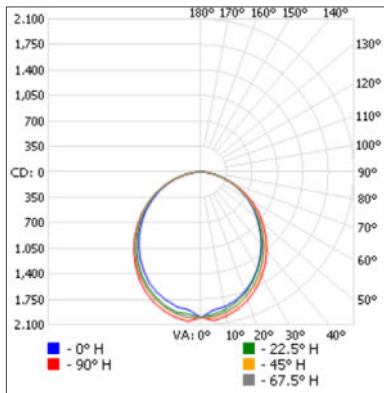

Zonal lumen summary

Zone	Lumens	% Fixture
0-30	1 526.8	28.2%
0-40	2 466.0	45.6%
0-60	4 256.4	78.6%
60-90	1 123.6	20.8%
70-100	497.6	9.2%
90-120	18.8	0.3%
0-90	5 380.0	99.4%
90-180	32.1	0.6%
0-180	5 412.0	100%

Illuminance at a distance

Center beam fc	Beam width
2.0'	4.9' 5.4'
4.0'	9.7' 10.8'
6.0'	14.6' 16.2'
8.0'	19.4' 21.6'
10.0'	24.3' 26.9'

Vert. spread: 101.1°
Horiz. spread: 106.8°

69165 • L2WMG-48-3C-G2 • 4 000K • 5 407.9 lm

Polar candela distribution

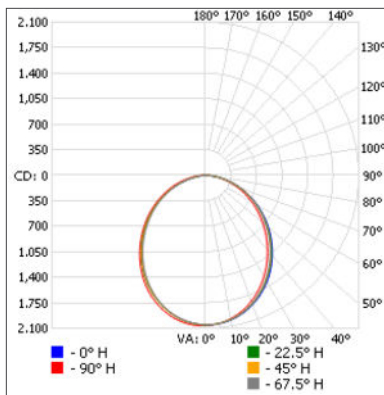

Zonal lumen summary

Zone	Lumens	% Fixture
0-30	1 552.9	28.7
0-40	2 499.4	46.2
0-60	4 273.5	79
60-90	1 089.7	20.1
70-100	480.8	8.9
90-120	21.5	0.4
0-90	5 363.2	99.2
90-180	44.7	0.8
0-180	5 407.9	100

Illuminance at a distance

Center beam fc	Beam width
2.0'	5.1' 4.9'
4.0'	10.2' 9.9'
6.0'	15.4' 14.8'
8.0'	20.5' 19.8'
10.0'	25.6' 24.7'

Vert. spread: 104.0°
Horiz. spread: 102.0°

68137 • L2WMG-48-1 • 4 946.4 lm

Polar candela distribution

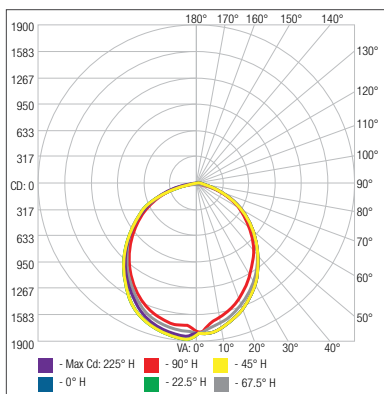

Zonal lumen summary

Zone	Lumens	% Fixture
0-30	1 366.9	27.6%
0-40	2 212.0	44.7%
0-60	3 834.6	77.5%
60-90	1 067.9	21.6%
70-100	513.6	10.4%
90-120	32.9	0.7%
0-90	4 902.5	99.1%
90-180	43.9	0.9%
0-180	4 946.4	100%

Illuminance at a distance

Center beam fc	Beam width
1.7'	4.7' 4.0'
3.3'	9.2' 7.8'
5.0'	10.9' 11.0'
6.7'	18.6' 15.9'
8.3'	23.0' 19.6'
10.0'	27.8' 23.7'

Vert. spread: 108.5°
Horiz. spread: 99.6°

¹ Complete IES files available on our website.

Data is based upon tests performed in a controlled environment. Actual performance can vary depending on operating conditions. All products are subject to change or may be discontinued any time without notice. Please contact your Stanpro customer service representative to confirm inventory levels at time of order.