

Series Spec Sheet

YLD

LED YARD LIGHT

3 CCT AND 3 POWER SELECTABLE

Twistlock Photocell Included

The YLD is an energy efficient dusk to dawn yard light. It is a versatile and economic LED light source and it was designed for barns and farms. The YLD comes standard with a twistlock photocell and features latest in LED technology allowing the user to control the color temperature and power by using the internal field adjustable integrated switches.

FEATURES AND SPECIFICATIONS

• Construction

Physical Characteristics

- Heavy-duty cast aluminum housing finished standard in a grey polyester powder coating finish.
- Polycarbonate Lens
- CCT and Power Select switches are placed discretely inside the housing
- Twistlock photocell included

Mounting

- Direct Wall Mount
- 15" Arm Mount Kit (sold separately as an accessory)

• Performance data

- Available in 3 000/4 000/5 000 K selectable color temperature
- 80+ CRI
- Electrical ratings: 120-277 V
- Estimated life of 50 000 hours to L70
- Operating temperature: -40 °C to 45 °C (-40 °F to 113 °F)
- 4kV Surge protection

• Compliances

- Meets requirements of ICES-005 5 for class B products
- cULus listed for wet locations
- IP65



OVERVIEW

Light source	LED
Watts (W)	72/96/120
Lumen output (lm)	9 485 - 15 680
Efficacy (lm/W)	124 - 150
Color temperature (K)	3 000/4 000/5 000
CRI	80+



¹ Based on a maximum usage of 12 hours per day.

² Not all products are qualified on the DLC QPL. To view our DLC qualified products, please consult the DLC Qualified Products List at www.designlights.org/search.

QUICK SHIP AND TECHNICAL SPECIFICATION TABLE 

Order code	Model number	DLC Unique ID	Watts (W)	Volts (VAC)	Color temp. (K) ¹	Lumen output (lm) ^{2,3}	Efficacy (lm/W)	CRI	Life L70 (hrs) ⁴	Tested hours LM-80 (hrs) ⁴	Calculated TM21 (hrs) ³	Beam angle (°)	Distribution type	BUG	Finish	Photo-cell ⁵	Dimming	Power factor	THD (%)	Traditional equivalent (W) MH HPS	Master case qty
------------	--------------	---------------	-----------	-------------	------------------------------	----------------------------------	-----------------	-----	-----------------------------	---------------------------------------	------------------------------------	----------------	-------------------	-----	--------	-------------------------	---------	--------------	---------	-----------------------------------	-----------------

CCT and Power Selectable Including a Twistlock Photocell

69175	YLD-PS120A-W-3C-PT	S-YOVADZ	72/96/120	120-277	3 000/4 000/5 000	10 698/ 13 334/15 680	140 - 150	80+	50 000	9 000	50 000	133	Type V	B3 U3 G3	Grey	Yes	No	0.99	0.0893	175-400	150-400	4
-------	--------------------	----------	-----------	---------	-------------------	-----------------------	-----------	-----	--------	-------	--------	-----	--------	----------	------	-----	----	------	--------	---------	---------	---

¹ Typical color temperature range: +/- 5 %.

² Lumen values are derived from photometric testing. Initial lumens range: +/- 10 %.

³ Lumen values are based on 4 000 K default programming. Please refer to the LUMEN SPECIFICATION TABLE for more details on other color temperatures.

⁴ Life hours are derived from IESNA LM-80-08 testing report and projected per IESNA TM-21-11 extrapolations.

LUMEN SPECIFICATION TABLE

Order code	Model number	Watts (W)	Fixture Current (A)	3 000 K			4 000 K			5 000 K		
				Lumen output (lm)	Efficacy (lm/W)	CRI	Lumen output (lm)	Efficacy (lm/W)	CRI	Lumen output (lm)	Efficacy (lm/W)	CRI
69175	YLD-PS120A-W-3C-PT	72	0.605-0.44	9485	133	80	10698	150	80	10198	143	80
		96	0.77-0.44	11679	127	80	13334	145	80	12875	140	80
		120	0.94-0.44	13870	124	80	15680	140	80	14896	133	80

DEFAULT PROGRAMMING

69175: 120 W / 4 000 K

ACCESSORIES (order separately)

Order code	Type
69176	15" ARM MOUNT KIT
PH0009	Shorting cap

DIMENSIONS AND WEIGHTS

69175

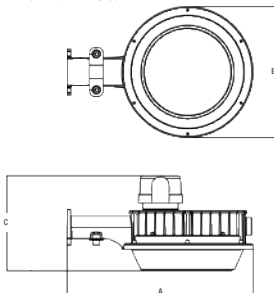

A in. (cm)	13.48 (34.25)
B in. (cm)	9.48 (24.10)
C in. (cm)	6.87 (17.47)
Net weight (lbs)	4.79

69176

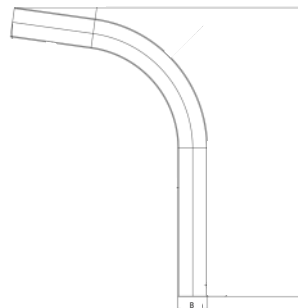

A in. (cm)	15.35 (39)
B in. (cm)	1.57 (4)
Net weight (lbs)	1.87

Data is based upon tests performed in a controlled environment. Actual performance can vary depending on operating conditions. All products are subject to change or may be discontinued any time without notice. Please contact your Stanpro customer service representative to confirm inventory levels at time of order.

PHOTOMETRIC DATA¹

69175 • YLD-PS120A-W-3C-PT • 72W • 4000K • 10 396.2lm

Polar candela distribution

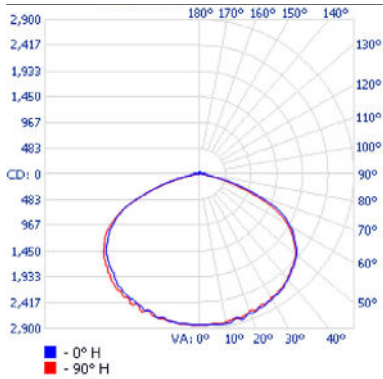

Zonal lumen summary

Zone	Lumens	% Lamp	% Fixture
0-30	2 333.2	22.4	22.4
0-40	3 990.2	38.4	38.4
0-60	7 816.5	75.2	75.2
60-90	2 341.0	22.5	22.5
70-100	883.7	8.5	8.5
90-120	155.3	1.5	1.5
0-90	10 157.5	97.7	97.7
90-180	238.8	2.3	2.3
0-180	10 396.2	100	100

Illuminance at a distance

Center beam fc		Beam width	
8.3'	41.0	39.4'	37.4'
16.7'	10.1	79.4'	75.3'
25.0'	4.52	118.8'	112.7'
33.3'	2.55	158.2'	150.2'
41.7'	1.63	198.1'	188.1'
50.0'	1.13	237.6'	225.5'

■ Vert. spread : 134.3°
■ Horiz. spread : 132.2°

69175 • YLD-PS120A-W-3C-PT • 96W • 4000K • 13 385.6lm

Polar candela distribution

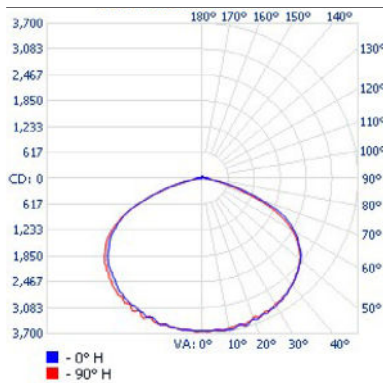

Zonal lumen summary

Zone	Lumens	% Lamp	% Fixture
0-30	3 033.1	22.4	22.4
0-40	5 134.6	38.4	38.4
0-60	10 059.6	75.1	75.2
60-90	3 018.0	22.5	22.5
70-100	1 141.8	8.5	8.5
90-120	200.4	1.5	1.5
0-90	13 077.6	97.7	97.7
90-180	308.1	2.3	2.3
0-180	13 385.6	100	100

Illuminance at a distance

Center beam fc		Beam width	
17.0'	12.6	80.9'	76.7'
34.0'	3.15	161.7'	153.5'
51.0'	1.40	242.6'	230.2'
68.0'	0.79	323.5'	306.9'
85.0'	0.50	404.3'	383.7'
102.0'	0.35	485.2'	460.4'

■ Vert. spread : 134.4°
■ Horiz. spread : 460.4°

69175 • YLD-PS120A-W-3C-PT • 120W • 4 000K • 15 303.6lm

Polar candela distribution

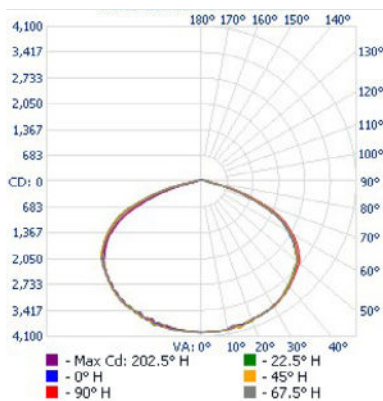

Zonal lumen summary

Zone	Lumens	% Lamp	% Fixture
0-30	3 287.6	21.5	21.5
0-40	5 639.4	36.8	36.8
0-60	11 138.6	72.8	72.8
60-90	3 710.6	24.2	24.2
70-100	1 559.1	10.2	10.2
90-120	320.1	2.1	2.1
0-90	14 849.2	97	97
90-180	454.4	3	3
0-180	15 303.6	100	100

Illuminance at a distance

Center beam fc		Beam width	
17.0'	13.8	83.7'	84.4'
34.0'	3.45	167.5'	168.9'
51.0'	1.54	251.2'	253.3'
68.0'	0.86	334.9'	337.8'
85.0'	0.55	418.7'	422.2'
102.0'	0.38	502.4'	506.6'

■ Vert. spread : 135.8°
■ Horiz. spread : 136.1°

¹ Complete IES files available on our website.

Data is based upon tests performed in a controlled environment. Actual performance can vary depending on operating conditions. All products are subject to change or may be discontinued any time without notice. Please contact your Stanpro customer service representative to confirm inventory levels at time of order.